

## User's Manual



Qualcomm aptX and Qualcomm TrueWireless are products of Qualcomm Technologies, Inc. and/or its subsidiaries. Qualcomm is a trademark of Qualcomm Incorporated, registered in the United States and other countries.



### Package Contents

- ① Main unit x 2 (L&R pair: detachable type MMCX earphones, flexible short cables pre-installed)
- ② Battery charge cradle x 1
- ③ USB cable for battery charge (500mm x 1)
- ④ Earphone tips (S,M,L) 1pair each
- ⑤ PU leather pouch
- ⑥ Logo sticker x 1
- ⑦ Instruction manual x 1

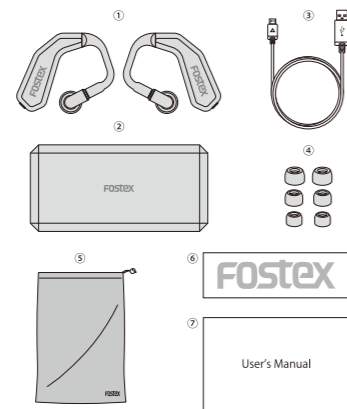

### Names and Functions

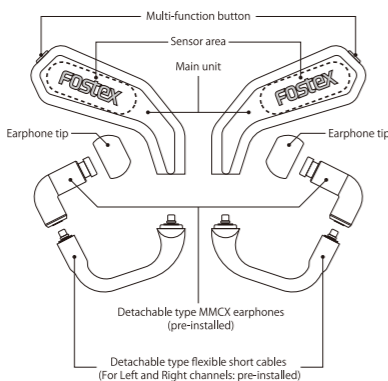

### Caution on attaching and detaching

Since there is an L and R marking on the back of the individual main unit and flexible short cable (inside the connector when attached), Be careful not to make a wrong connection.

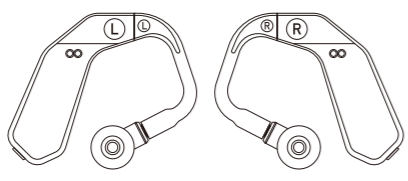

### How to wear TM2

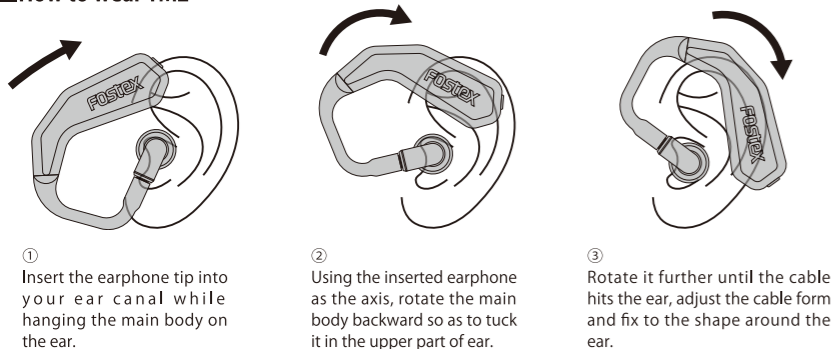

### How to operate TM2

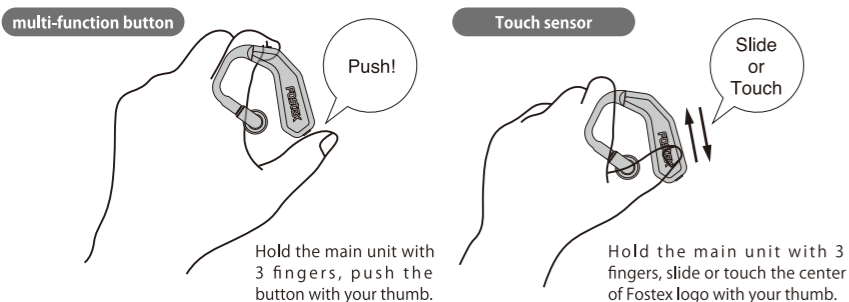

### How to charge battery

[ Battery charge cradle ]

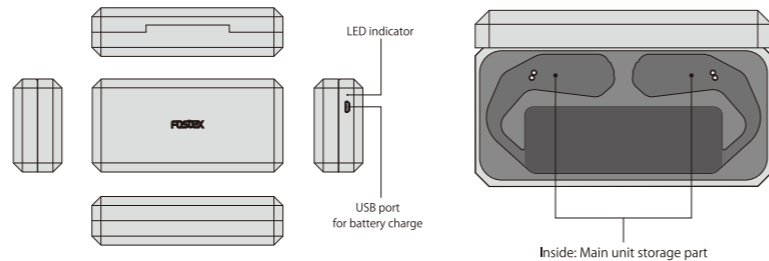

This product will be charged using the Battery charge cradle, which does not carry battery inside). Charge the battery before use.

\*Time to full charge: approx. 1h 30min

1. Open the lid of battery charge cradle and place the TM2 main units.
2. Connect micro USB connector of the included USB cable to the battery cradle and the other side of the cable to an off-the-shelf USB AC power adaptor to connect to AC outlet.
  - \*Do not use other cables than the included USB cable.
  - \* Be aware of connector direction when connecting.
  - \*Use a USB AC power adaptor with below 5V1A.
3. When battery charge starts, the LED indicator of cradle will blink slowly.
  - \*Refer to "Function and operation method, guidance and LED indication" on right.
4. After approx.1h 30min, battery charge will complete and LED indicator will be off.



### [Caution]

- In case battery charge will not complete even after 1h 30min, stop charging.
- Even if you do not use for a long time, please charge once every 6 months. It may totally self-discharge otherwise and become impossible to charge further.
- The TM2 built-in lithium ion battery is a consumable item. The available use time becomes shorter with the use period. However, if the use time becomes extremely short, it is the life of the battery.
- No function available when charging the battery.

### function and operation method, guidance and LED indication

#### Basic operations

Function/Status	Operation (same specifications on left and right)	Voice guidance	LED display
Powering ON (1)	Remove main unit from charging cradle	「Power ON」	Blinking 3 times in blue
Powering ON (2)	Press and hold the button for 3sec (When not placed to charging cradle)	「Power ON」	Blinking 3 times in blue
Powering OFF (1)	Place the main unit in the cradle	「Power OFF」	Blinking 3 times in red
Powering OFF (2)	Press and hold the button for 3sec (When not placed to charging cradle)	「Power OFF」	Blinking 3 times in red
Pairing: Pairing Start	Press and hold the button for 5sec	「Pairing」	Blinking fast in red and blue alternately
Pairing Successful	—	「Pairing Successful」	Blinking 3 times in blue
Pairing Failed	—	3min passed [Pairing Failed - Power Off]	Blinking 3 times in red
Battery remaining alert: Low Battery	—	[Low Battery] (Start warning when remaining time is 10 minutes)	(According to guidance) Blinking 4 times in red
Volume up	Touch the sensor area and slide up	"Short beep"	—
Volume down	Touch the sensor area and slide down	"Short beep"	—

#### Music playback

Play or Stop	Push the button once	"Short beep"	—
Skipping to the next song	Push the button twice (during playback)	"Short beep"	—
Cueing (song being played): Cue	Push the button 3 times fast (3 seconds or more after starting music)	"Short beep"	—
Skipping to the previous song	Push the button 3 times fast (3 seconds or after starting music)	"Short beep"	—
Fast Forward (Frame Advance)	While playing music, touch the sensor area for more than 2 seconds.	"Short beep"	—
Stopping Fast Forward (Frame Advance) and return to Playback mode.	Remove your finger from the sensor area or press the multi-function button once.	"Short beep"	—

#### Call operation

Incoming call (call start)	Push the button once	"Short beep"	—
Disconnecting call	Push the button once	"Short beep"	—

### How to pair

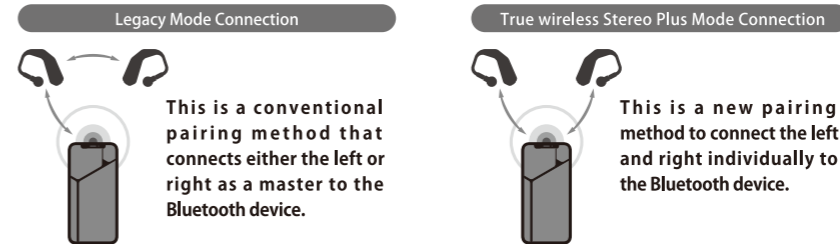

- ① The determination of both modes is performed automatically at the time of connection. Thus, please refer to the instruction manual of the connected Bluetooth device to check if it is compatible with True wireless Stereo Plus mode (hereinafter TWS Plus mode).
- ② At each time reconnecting, the legacy mode offers a roll swapping function that will automatically choose either the left or right whichever has the higher battery level as the master. Using the left and right batteries efficiently, it will offer longer operating time.

1. Enable the Bluetooth function of the Bluetooth device (smartphone, DAP etc.) to be connected. (Please refer to the instruction manual of the connected Bluetooth device.)
  2. Power is turned ON automatically when taking out the left and right main Units from the cradle.
    - \*In case of manual operation, hold down the multi-button for 3 seconds and then release the finger.
- Note: The initial unpacked status (factory default) is set to start Pairing mode (blue and red LEDs flashing alternately) when taking the LEFT unit off the cradle.
3. Select either left or right, and hold down the multi-button for about 5 seconds. The LED indicator blinks alternately in blue and red, and enter the pairing mode.
  4. Select "Fostex TM2 Left" or "Fostex TM2 Right" displayed in the device list on the Bluetooth device to be connected.
  5. When pairing is complete, the Bluetooth device will display "Connected".
  6. At the same time, connection processing with the other main unit is performed and "Bluetooth pairing request" is displayed on the Bluetooth device. Select "Pairing" or "Pair Set". The link between the left and right is performed, and pairing work will be completed.

#### [POINT]

- In TWS Plus mode, instead of the automatic link processed between left and right as described in the above 6, each of the left and right will directly perform pairing processing with the connected Bluetooth device, and the pairing work will be completed.
- After the power is turned OFF and then use it again, when it is removed from the cradle and turned ON, it is set to be automatically connected to the last used Bluetooth device.

### Initial setting (return to factory default) method

1. First, unplug the USB cable from the cradle.
2. Next, take out the left or right main Unit, hold down the multi-button for 15 seconds and then release the finger. The LED indicator will blink in blue rapidly.
3. Then, hold the multi-button of the other main Unit for 15 seconds and then release the finger. The LED indicator will blink in blue as well.
4. Under this condition (left and right LED rapidly blinking in blue), bring the left and right main Units close by about 2 cm. Both LED indicators will turn off once, and after about 2 seconds, only the left main Unit LED will flash in red and blue alternately.
5. In this state (Right: off, Left: red and blue fast flashing), place both main Units back to the cradle with no USB cable connected. Both LED indicators will be off and all information will reset to the initial state (factory default).
6. After that, when both Units are removed from the cradle, only the left body LED indicator blinks alternately in blue and red and it will automatically enter the pairing mode.

Be careful not to hold the button for more than 15 seconds during pairing operation.

### Charging cradle LED indication

Status	Red LED	Green LED
Connect the USB cable to USB AC power adaptor that connects to AC outlet.	When TM2 main unit not placed	Blinking once in red
Connect the USB cable to USB AC power adaptor that connects to AC outlet.	When TM2 main unit placed (Charging battery)	Slow blinking in red
—	TM2 main unit (when 90% or more charging complete)	—
—	TM2 charging complete	Lit in Green
—	—	Lights off

### Specifications

- ▼ Bluetooth
  - Firmware version: Bluetooth ver. 5.0
  - Output class: Class 2
  - Communication method: FHSS
  - Communication distance: approx.10m
  - Frequency band: 2.4 GHz (2402 – 2480MHz)
  - Corresponding profile: A2DP1.3, AVRCP1.6, HSP 1.2, HFP 1.7
  - Supported codec: AAC, apt-X, SBC
  - Supported content protection: SCMS-T
  - Transmission frequency range: 20Hz – 20kHz
- ▼ Audio specifications (Earphone stand-alone specification)
  - Format: Dynamic
  - Driver unit: φ6mm
  - Playback frequency range: 10Hz–40kHz
  - Impedance: 16 ohm
  - Dimensions: W21.6 x D14.6 x H6.5mm
- ▼ Microphone specifications
  - Format: MEMS
  - Directivity pattern: omnidirectional / CVC noise canceling mounted
- ▼ Remote Controller specifications
  - Music playback: play, pause, song feed, tune backward, cue, crawl, fast forward, volume adjustment
  - Call operation: reception, call cut
- ▼ Other specifications
  - Main unit Dimensions: W40.2 x D48.2 x H8.8mm
  - Mass: 11g×2 (Incl.Cable & Earphone)
  - Main unit power supply: DC 3.7 V Built-in rechargeable lithium-ion battery
  - Charging time: approx. 1h 30min (full charge)
  - Continuous playback / talk time: Up to approx. 10h
  - Waterproof protection grade: IPX 5
- ▼ Battery charge cradle specifications
  - Input port: micro USB (type B)
  - Dimensions: W138 x D67 x H35
  - Mass: 128g (except TM2 main unit)
- ▼ Accessories
  - USB cable, earpieces (S,M,L: M size installed), PU leather pouch, sticker, instruction manual

## MEMO

# Fostex

## Safety information for Fostex Earphones and Headphones Sicherheitsinformationen für Fostex-Ohrhörer und Kopfhörer Informations de sécurité pour les écouteurs et les casques d’ écoute Fostex Información de seguridad de los audífonos y auriculares Fostex

## English

Read this manual before use.
This manual describes Warning and Caution for safe use of Fostex products.
Keep the manual in a convenient place for future reference.

**Warning**
Warning; ignoring the warning may cause death or severe injury as a result of incorrect usage.

**Caution**
Caution; ignoring the caution may cause moderate injury or property damage as a result of incorrect usage.

## Warning

- Listening to audio at excessive volumes may cause permanent hearing damage. Avoid prolonged usage and use at as low volume as possible.
- Do not use when driving vehicles such as automobiles, motorcycles or bicycles. Doing so is a traffic offence and may cause traffic accidents.
- Do not use in places where not hearing the surrounding sound is dangerous, such as railway crossings, train platforms, near heavy traffic and construction sites.
- Keep this product out of reach of small children. Handling by children may cause death or severe injury. This product includes parts that may cause a risk of choking or suffocation.
- Do not modify this product. Doing so may cause personal injury or product failure.

## Caution

- Do not give physical shock to this product. Using a damaged product may cause personal injury.
- Do not get this product wet (except waterproof models). It may cause failure. Be careful when using outdoors, such as in rainy or snowy conditions, or at the beach.
- In case of product failure, ask your original retailer or Fostex for servicing.
- Avoid leaving this product in a closed car or under direct sunlight. High temperatures may result in failure.
- Before connecting to other audio products, read the instruction manual of the audio product. Turn off the power and set the volume of the other product to minimum when connecting this product.
- Sound leaks from the earphones if playback volume is too high. Be careful not to cause problems for the people around you.
- When disconnecting from other audio products, do not pull the cord too forcefully. Pulling the cord forcefully may result in wire damage or product malfunction.
- Stop use immediately if you do not feel well while using this product.
- Stop using as soon as possible if the earpiece does not agree with your skin.
- Firmly attach the earpiece. If just the earpiece remains in your ear, it may cause injury or illness.
- Remove and insert the earphones into your ears carefully and slowly. Carelessly removing or inserting the earphones may damage your ears.

## Deutsch

Lesen Sie diese Bedienungsanleitung vor der Verwendung durch.
Diese Anleitung beschreibt Warnungen und Vorsichtsmaßnahmen für die sichere Verwendung von Fostex-Produkten.
Bitte heben Sie diese Bedienungsanleitung für zukünftiges Nachschlagen an sicherer Stelle auf.

**Warnung**
Warnung; wenn die Warnung ignoriert wird, besteht die Gefahr von Unfällen mit schweren Verletzungen oder Todesfolge durch falsche Verwendung.

**Vorsicht**
Vorsicht; wenn dieser Vorsichtshinweis ignoriert wird, besteht die Gefahr von Unfällen mit Verletzungen oder Sachschäden durch falsche Verwendung.

## Warning

- Hören von Ton mit zu hoher Lautstärke kann permanente Gehörschäden verursachen. Vermeiden Sie sehr lange Verwendung und stellen Sie die Lautstärke so niedrig wie möglich ein.
- Nicht beim Führen von Fahrzeugen wie Automobilen, Motorrädern oder Fahrrädern verwenden. Dies ist ein Verkehrsdelikt und kann Verkehrsunfälle verursachen. Nicht an Orten verwenden, wo es wichtig ist, Umgebungsgeräusche wahrzunehmen, wie an Bahnübergängen, auf Bahnsteigen, im Straßenverkehr und auf Baustellen.
- Halten Sie das Produkt außer Reichweite kleiner Kinder. Handhabung durch Kinder kann zu Unfällen mit schweren Verletzungen oder Todesfolge führen. Dieses Produkt enthält kleine Teile, die möglicherweise verschluckt werden und Erstickungen verursachen können.
- Dieses Produkt darf nicht modifiziert werden. Dabei besteht die Gefahr von Verletzungen oder Fehlfunktionen des Produkts.

## Caution

- Dieses Produkt darf nicht starken Erschütterungen ausgesetzt verwenden. Verwendung eines beschädigten Produkts kann Verletzungen verursachen.
- Lassen Sie dieses Produkt nicht nass werden (ausgenommen wasserfeste Modelle). Dadurch kann eine Fehlfunktion verursacht werden. Seien Sie bei Verwendung im Freien vorsichtig, wie im Regen oder Schnee oder am Strand.
- Bei Betriebsstörungen wenden Sie sich zur Wartung an den Fachhändler oder an Fostex.
- Lassen Sie das Produkt nicht in einem geschlossenen Fahrzeug oder im direkten Sonnenlicht liegen. Hohe Temperaturen können Fehlfunktionen verursachen.
- Vor dem Anschließen an andere Audioprodukte lesen Sie die Bedienungsanleitung des Audioprodukts. Schalten Sie beim Anschließen dieses Produkts die Stromversorgung aus und stellen Sie die Lautstärke am andern Produkt minimal ein.
- Wenn die Wiedergabelautstärke zu hoch ist, dringt Ton vom Kopfhörer nach außen. Achten Sie darauf, dadurch nicht andere Menschen in der Umgebung zu belästigen.
- Beim Abtrennen oder Anschließen anderer Audioprodukte ziehen Sie nicht gewaltsam am Kabel. Wenn stark am Kabel gezogen wird, kann das Kabel beschädigt werden, oder es können Fehlfunktionen verursacht werden.
- Beenden Sie die Verwendung sofort, wenn Sie sich bei der Verwendung dieses Produkts unwohl fühlen.
- Beenden Sie die Verwendung so schnell wie möglich, wenn das Produkt Ihre Haut reizt.
- Bringen Sie das Ohrstück fest an. Wenn das Ohrstück in Ihrem Ohr stecken bleibt, kann es zu Verletzungen oder Erkrankungen führen.
- Sie müssen die Ohrhörer immer vorsichtig und langsam in die Ohren setzen und davon abnehmen. Durch unvorsichtiges Einsetzen oder Abnehmen können Verletzungen an den Ohren verursacht werden.

## Declaration of EC Directive

This equipment is compatible with the EMC Directive (2004/108/EC) - Directive on approximation of member nation’s ordinance concerning the electromagnetic compatibility and with the Low Voltage Directive (73/23/EEC) - Directive on approximation of member nation’s ordinance concerning electric equipment designed to be used within the specified voltage range.

The Affect of Immunity on This Equipment
The affect of the European Specification EN61000-6-1 (coexistence of electromagnetic waves - common immunity specification) on this equipment are as shown below.
In the electrical fast transient/burst requirements, surge, conducted disturbances by radio-frequency fields, power frequency magnetic field, radiate electromagnetic field requirements and static electricity discharging environment, this could be affected by generation of noise in some cases.

## FOSTEX DISTRIBUTORS LIST IN EUROPE

<p><b>Austria</b> NAME: Mega Audio GmbH ADD: Stromberger Str. 32, 55411 Bingen, Germany TEL: (+49) 6721-94330, FAX: (+49) 6721-32046 Email: info@megaaudio.de Web Site: http://www.megaaudio.de</p>	<p><b>Norway</b> NAME: Siv. Ing. Benum AS ADD: P. O. Box 145, Vinderen, 0319 Oslo, Norway TEL: (+47) 2213 9900, FAX: (+47) 2214 8259 Email: post@benum.no Web Site: http://www.benum.no</p>
<p><b>Belgium</b> NAME: XLR sprl/bvba ADD: Pierre Strauwenstraat 24, 1020 Brussels,Belgium TEL: (+32) 2 520 0827, FAX: (+32) 2 521 1977 Email: info@xrpro.be Web Site: http://www.xrpro.be</p>	<p><b>Poland</b> NAME: MIP sp. z o.o ADD: Działowska 12, Warszawa, Poland TEL: (+48) 22 424 8254 Fax: (+48) 22 855 93 80 Email: biuro@mip.biz.pl Web Site: http://www.mip.biz</p>
<p><b>Czecho</b> NAME: Praha Music Center spol s.r.o. ADD: Ocelarska 937/39, Praha 9, 190 00, Czecho TEL: (+420) 226-011-111, FAX: (+420) 226-011-112 Email: info@pmc.cz Web Site: http://www.pmc.cz</p>	<p><b>Russia</b> NAME：？？？ ADD: 1st Krasnoselskiy lane, 7/9A, bld. 11, 3rd floor Moscow Russia 107140 Tel: +7(499) 705-1552 Fax: +7 495 276 2076 Email: info@blade.ru Web Site: http://www.blade.ru/</p>
<p><b>Denmark</b> NAME: SC Sound A/S ADD: Dalgas Alle 15, DK-6600 Vejen, Denmark TEL: (+45) 4399 8877, FAX: (+45) 4399 8077 Email: mail@sc-sound.dk Web Site: http://www.sc-sound.dk</p>	<p><b>Russia</b> NAME: Audio Mania LLC (Speaker Component Only) ADD: PO BOX 15, 08340Vilassar de Mar, Barcelona, Spain Tel: +7 495 2680468 Email: info@audiomania.ru Website: http://www.audiomania.ru</p>
<p><b>France</b> NAME: Mega Audio GmbH ADD: Stromberger Str. 32, 55411 Bingen, Germany TEL: (+49) 6721-94330, FAX: (+49) 6721-32046 Email: info@megaaudio.de Web Site: http://www.megaaudio.de</p>	<p><b>Spain &amp; Portugal</b> NAME: ATCONSUMER (Consumer, Hi-Fi system &amp;Speaker Components) ADD: PO BOX 15, 08340Vilassar de Mar, Barcelona, Spain TEL: (+34) 609 288310 Email: info@atconsumer.es Web Site: http://www.atconsumer.es</p>
<p><b>France</b> NAME: TLHP / Son Lumiere Concept (Speaker Component Only) ADD: 10 rue du Passavent, Zone du Val d’Orson, 35770 Vern sur Seiche Tel: +33(0)892707657 Email: info@toutlehautparleur.com Website: http://www.toutlehautparleur.com/marque-tlhp.html</p>	<p><b>Sweden</b> NAME: Benum Nordic AS ADD: Aldermansvagen 17, 171 48 Solna, Sweden TEL: (+46) 8 207710 Email: sweden@benum.com Web Site: http://www.benum.se</p>
<p><b>France</b> NAME: Hamy Sound (Headphones and USB DAC Only) ADD: 28 Rue Edith Cavell, 92400 Courvevoie,France TEL: (+33) 1 4788 4702, FAX: (+33) 1 4789 4872 Email: sav@hamysound.com Web Site: http://www.hamysound.com</p>	<p><b>Sweden, Norway, Finland &amp; Denmark</b> NAME: Supersonic Svenska AB (Speaker Components Only) ADD: PO BOX 42043, 126 12 Stockholm, Sweden TEL: (+46) 8 744 4700 Email: johan@supersonic.se</p>
<p><b>Germany</b> NAME: Mega Audio GmbH ADD: Stromberger Str. 32, 55411 Bingen, Germany TEL: (+49) 6721-94330, FAX: (+49) 6721-32046 Email: info@megaaudio.de Web Site: http://www.megaaudio.de</p>	<p><b>Switzerland</b> NAME: Audio Bauer Pro AG ADD: Bernerstrasse-Nord 182, CH-8064 Zurich, Switzerland TEL: (+41) 44 432 3230, FAX: (+41) 44 432 6558 Email: info@audio-bauerpro.ch Web Site: http://www.audio-bauerpro.ch</p>
<p><b>Greece</b> NAME: Bon Studio S.A ADD: 6 Zaimi Street, Exarchia, 106.83 Athens, Greece TEL: (+30) 210-3809-605, 606, 607, 608 FAX: (+30) 210-3845-755, 210-3827-868 Email: bon@bonstudio.gr Web Site: http://www.bonstudio.gr</p>	<p><b>Turkey</b> NAME: Extreme Audio ADD: Sheraton Istanbul Maslak Kat B2 Buykdere Cad. Nr:233 Uçyol Mevkii 34398 Maslak Istanbul Turkey Tel: +90 444 3760 Fax: +90 212 285 0073 Email: bahadir@extreme-audio.com Website: http://www.extreme-audio.com</p>
<p><b>Hungary</b> NAME: Mega Audio GmbH ADD: Stromberger Str. 32, 55411 Bingen, Germany TEL: (+49) 6721-94330, FAX: (+49) 6721-32046 Email: info@megaaudio.de Web Site: http://www.megaaudio.de</p>	<p><b>UK</b> NAME: SCV London ADD: Unit C1 Belcon Industrial Estate, Geddings Road, Hodesdon, Hertfordshire, EN11 0NT, UK TEL: (+44) 03 301 222500, FAX: (+44) 20-8418-0624 Email: fostex@scvlondon.co.uk Web Site: http://www.scvlondon.co.uk</p>
<p><b>Italy</b> NAME: Backline S.u.r.l. ADD: Via dell’ Aprica, 16 - 20158 Milano, Italy TEL: (+39) 02 6901 5709, FAX: (+39) 02 6901 5645 Email: info@backline.it Web Site: http://www.backline.it</p>	<p><b>Ukraine</b> NAME: A &amp; T Trade Petrosshop ADD: 29, Obolonskaya Str., Kiev, Ukraine 04071 TEL: (+380) 44-462-5358, FAX: (+380) 44-462-5092 Email: attrade@attrade.kiev.ua Web Site: http://kiev.attrade.ru</p>
<p><b>Italy</b> NAME: Art of Music sas (Hi-Fi system &amp; Speaker Components) ADD: Via Dal Lino 23/2, 40134 Bologna, Italy TEL: (+39) 347 2532215 Email: artofmusic@libero.it Web Site: http://www.ballacoustics.it</p>	<p><b>Ukraine</b> NAME: Era in Ear ADD: 1 Maryanenko Lane Kharkiv, Ukraine Tel: +38 044 221 1980 Email: sale@era-in-ear.com Website: http://era-in-ear.com</p>
<p><b>The Netherlands</b> NAME: Mafico BV ADD: Weg en Bos 2 2661 DH Bergschenhoek Nederland Tel: +31 (0)10 - 414 8426 Fax: +31 (0)10 - 404 8863 Email: info@mafico.com Website: www.mafico.com</p>	

**FCC Statement:**
This device complies with part 15 of the FCC Rules. Operation is subject to the following two conditions:
(1) This device may not cause harmful interference, and
(2) this device must accept any interference received, including interference that may cause undesired operation.

**NOTE:** This equipment has been tested and found to comply with the limits for a Class B digital device, pursuant to part 15 of the FCC Rules. These limits are designed to provide reasonable protection against harmful interference in a residential installation.
This equipment generates, uses and can radiate radio frequency energy and, if not installed and used in accordance with the instructions, may cause harmful interference to radio communications. However, there is no guarantee that interference will not occur in a particular installation.
If this equipment does cause harmful interference to radio or television reception, which can be determined by turning the equipment off and on, the user is encouraged to try to correct the interference by one or more of the following measures:
—Reorient or relocate the receiving antenna.
—Increase the separation between the equipment and receiver.
—Connect the equipment into an outlet on a circuit different from that to which the receiver is connected.
—Consult the dealer or an experienced radio/TV technician for help.
Changes or modifications not expressly approved by the party responsible for compliance could void the user’s authority to operate the equipment.

**IC Statement:**
This device complies with Industry Canada license-exempt RSS standard(s).
Operation is subject to the following two conditions: (1) this device may not cause interference, and (2) this device must accept any interference, including interference that may cause undesired operation of the device.
Le present appareil est conforme aux CNR d’Industrie Canada applicables aux appareils radio exempts de licence. L’exploitation est autorisee aux deux conditions suivantes: (1) l’appareil ne doit pas produire de brouillage, et (2) l’utilisateur de l’appareil doit accepter tout brouillage radioelectrique subi, meme si le brouillage est susceptible d’en compromettre le fonctionnement.

**Taiwan regulatory information(NCC)**
低功率電波輻射性電機管理辦法
第十二條 經型式認證合格之低功率射頻電機,非經許可,公司、商號或使用者均不得擅自變更頻率、加大功率或變更原設計之特性及功能。
第十四條 低功率射頻電機之使用不得影響飛航安全及干擾合法通信;經發現有干擾現象時,應立即停用,並改善至無干擾時方得繼續使用。
前項合法通信,指依電信法規定作業之無線電通信。
低功率射頻電機須忍受合法通信或工業、科學及醫療用電波輻射性電機設備之干擾。

**FCC IC**
FCC ID : 2ASG7-TM2
IC : 24760-633096

**ETSI**
**T** D19-0013 202
**R** 202-SM H 026